



TOWN OF WATERTOWN CONNECTICUT

51 Depot Square Business Center

Suite 502 • Watertown, Connecticut 06795-2200

Planning and Zoning, Zoning Board of Appeals, Conservation Commission/Inland Wetland Agency

Telephone: (860) 945-5266

Fax: (860) 945-2704

Website: www.watertownct.org

To: Conservation Commission/Inland Wetland Agency

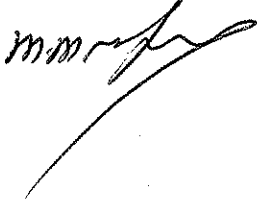
From: Moosa Rafey, Wetlands Enforcement Officer 

Date: May 4, 2009

Subject: **Field Trip on Saturday, June 20, 2009**

Commission members, applicants and/or their agents will meet on site as follows on **Saturday, June 20, 2009.**

- 09:30 AM** Application #669 of Karen and Richard Wither for construction of a deck and shed within upland review area at 60 Raspberry Road, Watertown, CT.
- 10:10 AM** Application #671 of Dominic DiNunzio for two lot residential subdivision located at 109 Buckingham Street, Oakville, CT.

If you are unable to attend, please call the Planning and Zoning Office at (860) 945-5266.

CC: Town Clerk
Robert Green
Dominic DiNunzio
Karen and Richard Wither

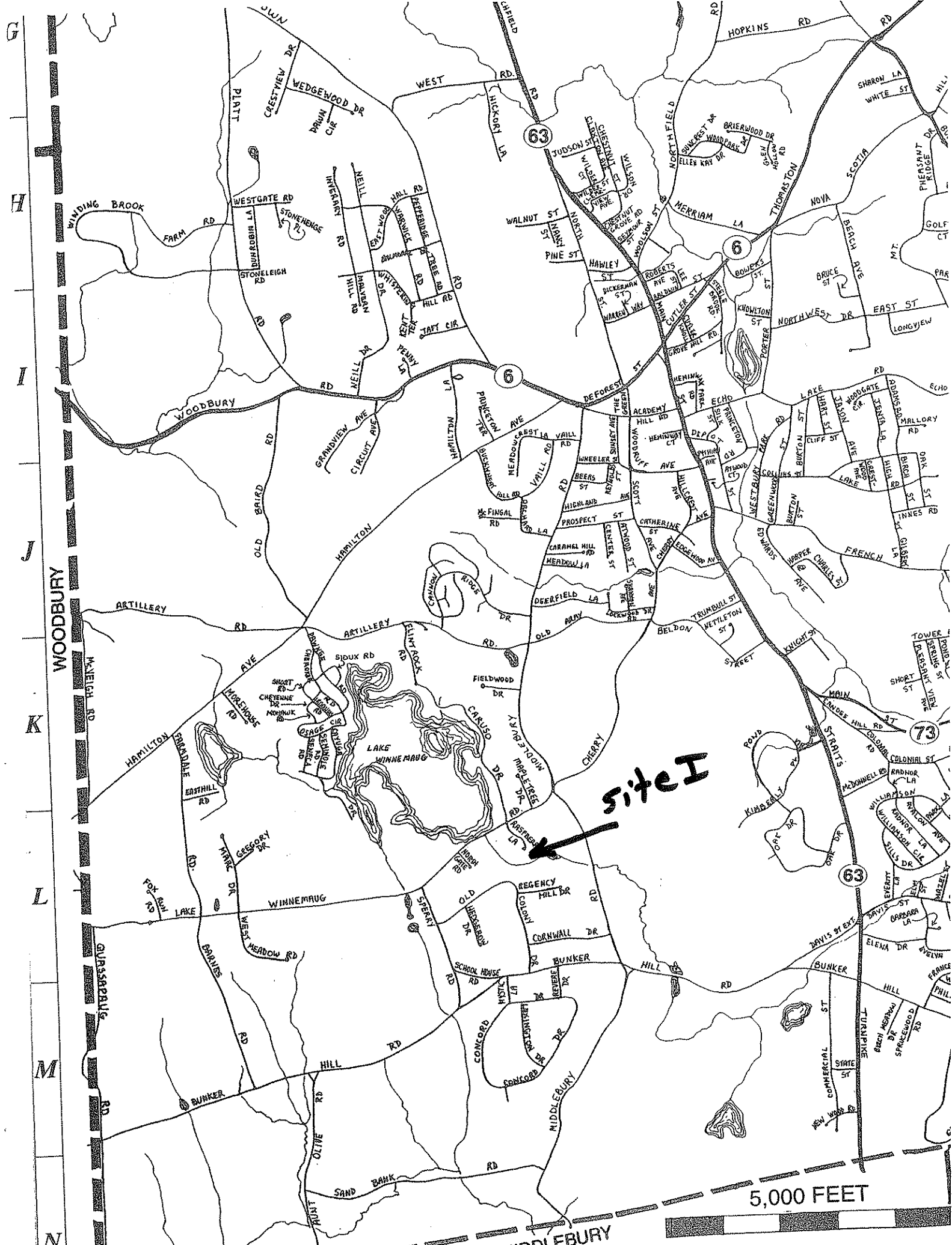

site I



5,000 FEET

G
H
I
J
K
L
M
N

WOODBURY

MIDDLEBURY

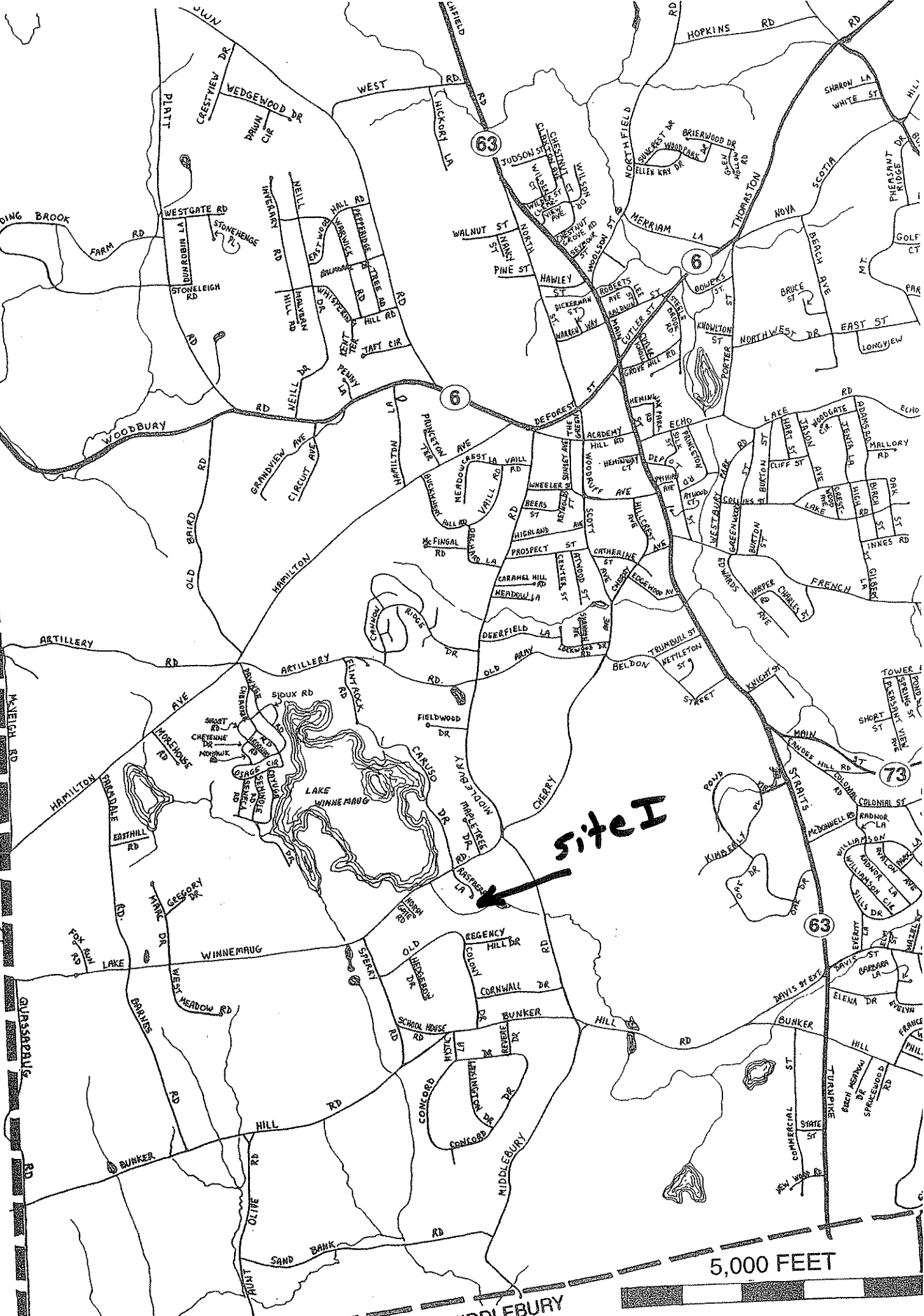

Free Pickup & Delivery
Tel. 860.274.6422 • Fax. 860.945.9266
36 ZOAR AVE. • OAKVILLE, CT 06779

1230 MAIN STREET
WATERTOWN, CT 06795
(860) 274-2501

1-800-523-232
(860) 754-250
FAX (860) 274-472

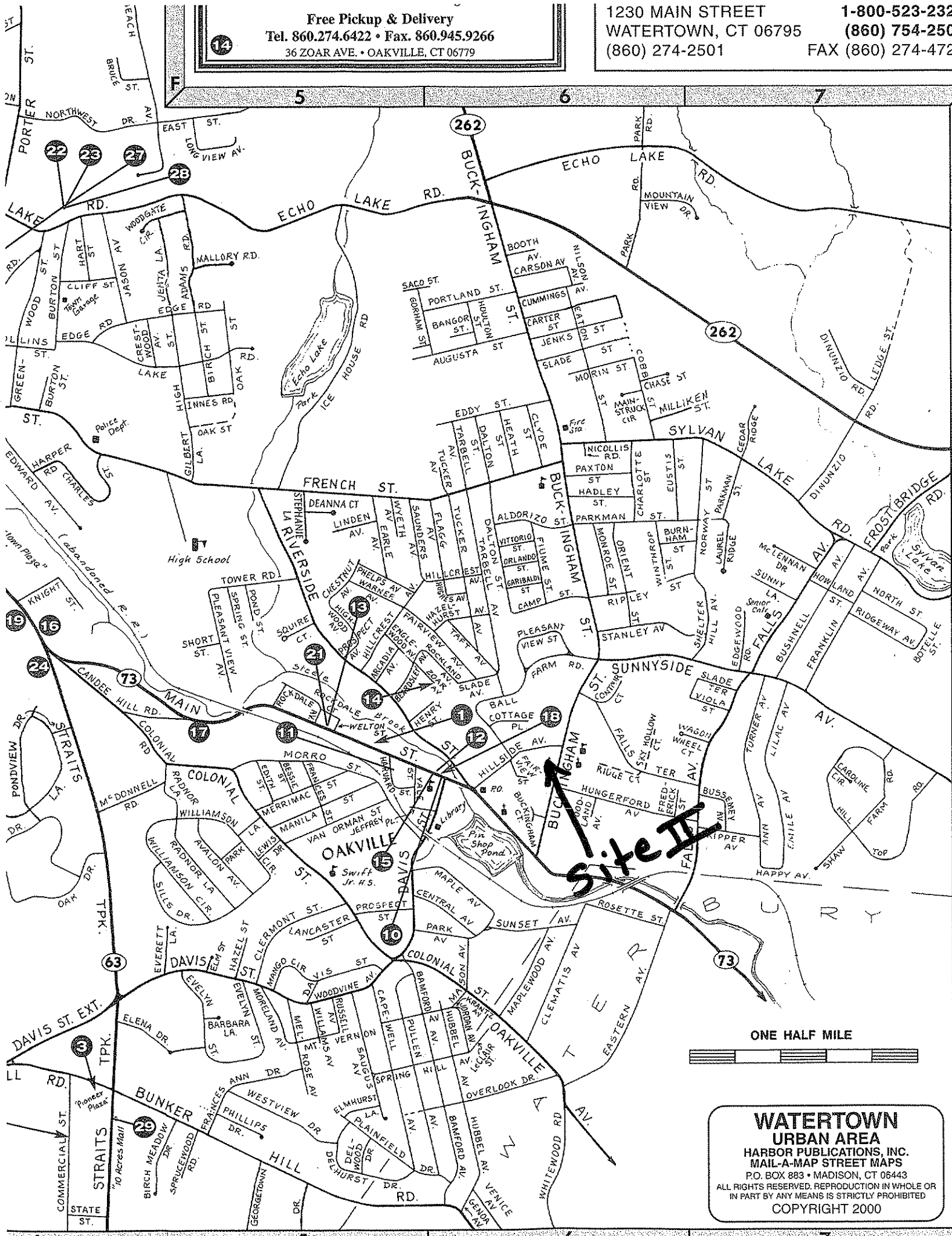

WATERTOWN URBAN AREA
HARBOR PUBLICATIONS, INC.
MAIL-A-MAP STREET MAPS
P.O. BOX 883 • MADISON, CT 06443
ALL RIGHTS RESERVED. REPRODUCTION IN WHOLE OR IN PART BY ANY MEANS IS STRICTLY PROHIBITED
COPYRIGHT 2000